

# FLOW METER

## Model E



KYTOLA® variable area flow meter model E is made from clear acrylic. It is available in single-tube and multi-tube versions. Model E is equipped with a flow adjustment valve and is also available in customized designs.

### FEATURES

- Acrylic body
- Flow adjustment valve
- Several flow ranges
- Clear, easy to read scale

### TYPICAL APPLICATIONS

- Water- and air purgings
- Gas measurements
- Liquid measurements

### OPTIONS

- Scale for alternative liquids and gases
- Special scale markings
- Thread adapters
- Multi-tube versions
- Viton® or EPDM seals





## Technical data E

<b>Model</b>	<b>EK-</b>	<b>EH-</b>
Weight	170 g	200 g
Valve housing / plugs	Nylon	AISI 316
Valve spindle	AISI 316	
Body	Acrylic (PMMA)	
Seals	Nitrile (*Viton®, EPDM)	
Max. pressure	20 bar (30 bar / +30°C)	
Max. temperature	+75°C	
Connections	BSP 1/4", Thread adapters must be used for NPT-connections	
Accuracy	± 5 % F.S. (H <sub>2</sub> O, +20°C)	
	*) Special construction on request	

E				
				<b>Special feature</b>
		H		Hand knob in valve
		V		Viton® -seals
				<b>Scale</b>
		A		H <sub>2</sub> O (l/min) at +20°C
		R		Air (NI/min) at +20°C / 101,3 kPa
				<b>Flow range</b>
				<b>H<sub>2</sub>O</b> <b>Air</b>
		2K		2 - 16 ml/min    0,1 - 0,8 NI/min
		2L		2,5 - 30 ml/min    0,1 - 1,2 NI/min
		2M		5 - 55 ml/min    0,2 - 1,8 NI/min
		2N		10 - 80 ml/min    0,4 - 2,6 NI/min
		3K		0,01- 0,11 l/min    0,5 - 5,5 NI/min
		3L		0,02 - 0,18 l/min    0,5 - 7 NI/min
		3M		0,025 - 0,3 l/min    1 - 9 NI/min
		3N		0,05 - 0,45 l/min    1 - 12 NI/min
		4B		0,05 - 0,5 l/min    2 - 20 NI/min
		4A		0,1 - 1,1 l/min    2 - 36 NI/min
		5E		0,2 - 1,6 l/min    7,5 - 47,5 NI/min
		5S		0,2 - 2,2 l/min    5 - 70 NI/min
		5F		0,5 - 2,5 l/min    10 - 90 NI/min
				<b>Valve housing / plug material</b>
		K		Nylon
		H		AISI 316
				<b>Tubes</b>
				Single tube
		N		Number of tubes (2-12)

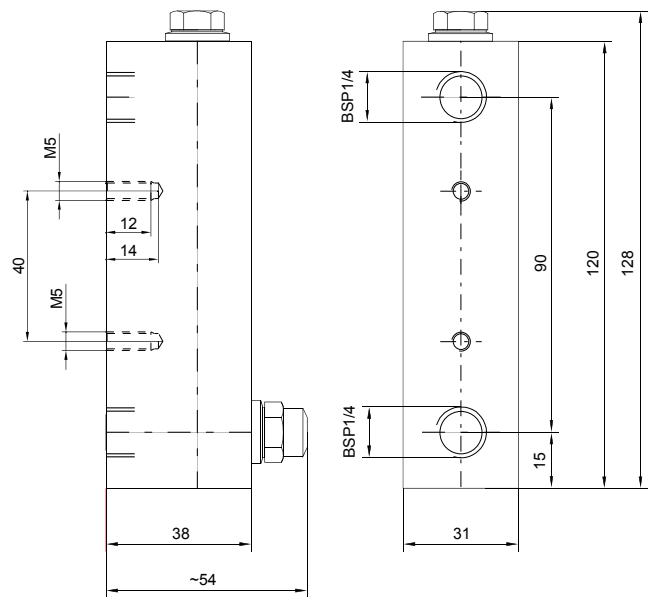

Note, thread adapters must be used for NPT-connections



**KYTOLA OY • Olli Kytolan tie 1**  
**P.O. Box 5 • FI-40951 MUURAME • FINLAND**  
**Phone +358 207 7906 90 • Fax +358 14 631 419**  
**E-mail sales@kytola.com • www.kytola.com**

MANUFACTURER

LOCAL REPRESENTATIVE